

TORQUE TUBE • CHAIN COUPLINGS

CHAIN COUPLINGS

CHROME MOLY STEEL, HEAT TREATED

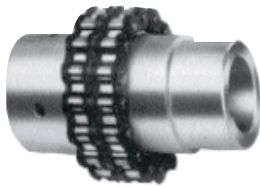

Only the finest material and workmanship go into the manufacturing of this coupling. 50 pitch chain - 14 teeth. Comes with seal. **SMALL BLOCK CHEVY ONLY 1" SHAFT SIZE. A MACHINING CHARGE WILL APPLY FOR ALL SHAFTS OTHER THAN 1".**

Item No.
767

JET H-JOINT ASSEMBLY

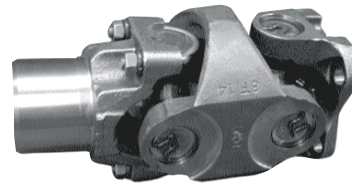

These 1310 or 1350 series H-Joints have a 1-3/8" 10-spline stub shaft which fit the Berkeley, Jacuzzi and Bay Jet units.

| Drive Line Series | Item No. |
|---------------------|----------|
| 1310 - 7-7/16" Long | 844 |
| 1350 - 8" Long | 843 |

SHORT TORQUE TUBE



Identical to our custom torque tube assemblies below. The running position lengths are listed below.

| Drive Line Series | Item No. |
|-------------------|----------|
| 10-1/2" 1310 | 834 |
| 11" 1350 | 835 |
| 13" 1350 | 836 |

H-JOINT ASSEMBLY



These 1310 H-Joints offer the shortest possible U-Joint assemblies. Only 5 1/2" long.

| Drive Line Series | Item No. |
|-------------------|----------|
| 1310 | 846 |

CUSTOM TORQUE TUBE ASSEMBLIES



These are the finest Spicer Tube and U-Joint Assemblies offered in the marine industry. Included in these assemblies are two U-Joints, Spline and Tube. Sizing to your requirements is available. Give dimensions from flange face at engine to flange face at V-drive.

TURBO 400 DRIVE LINE IS AVAILABLE. SPECIAL ORDER ONLY.

| 1310 Series Stock Length | Diameter of Tube | Item No. |
|--------------------------|------------------|----------|
| 24" | 2 1/2" | 837 |
| 36" | 2 1/2" | 839 |
| 48" | 2 1/2" | 841 |
| 1350 Series Stock Length | Diameter of Tube | Item No. |
| 24" | 3" | 838 |
| 36" | 3" | 840 |
| 48" | 3" | 845 |
| Turbo 400 Drive Line | | 848 |

V-DRIVE AND FRONT ENGINE COUPLINGS

CRANKSHAFT TAKE-OFF WITH V-PULLEY



CAD PLATED STEEL

V-Belt pulley groove is an integral part of this power take-off. Perfect for driving a generator or water pump.

FOR INTERNALLY BALANCED ENGINES ONLY. WHEN ORDERING SPECIFY ENGINE.

| Drive Line Series | Item No. |
|-------------------|----------|
| 1310 | 862 |
| 1350 | 863 |

CRANKSHAFT TAKE-OFF



CAD PLATED STEEL

Available for most popular automotive engines. Power take-offs used to couple cranking end of engine to drive line.

FOR INTERNALLY BALANCED ENGINES ONLY. WHEN ORDERING SPECIFY ENGINE.

| Drive Line Series | Item No. |
|-------------------|----------|
| 1310 | 860 |
| 1350 | 861 |

V-DRIVE FLANGE TAKE-OFF



CAD PLATED STEEL

| Drive Line Series | Bore Size | Item No. |
|-------------------|-----------|----------|
| 1310 | 1" | 86416 |
| 1310 | 1-1/8" | 86418 |
| 1310 | 1-1/4" | 86420 |
| 1310 | 1-3/8" | 86422 |
| 1350 | 1" | 86516 |
| 1350 | 1-1/8" | 86518 |
| 1350 | 1-1/4" | 86520 |
| 1350 | 1-3/8" | 86522 |

BORG WARNER TRANSMISSION FLANGES



CAD PLATED STEEL

Flanges are for the 4" and 5" diameter Borg Warner 71 and 72, EXCEPT the 864-B and 864-E which are for a Casale C-500 ONLY.

| Description | Item No. |
|--------------------------------|----------|
| 1" Male 71 B/W - 4" | 864-A |
| 1" Male Spicer Casale- 4" | 864-B |
| 1" Taper Male 71 B/W - 4" | 864-C |
| 1-1/8" Male 71 B/W - 4" | 864-D |
| 1-1/8" Male Spicer Casale - 4" | 864-E |
| 1" Male 72 B/W - 5" | 865-A |
| 1-1/8" Male 72 - 5" | 865-B |

COUPLERS • COLLARS • PROP NUTS • KEYS • PINS

SPLIT SLEEVE COUPLER - STEEL



This type of coupler is used on V-drives with 1" shafts.

| Length | O.D. | I.D. | Item No. |
|---------------|------|------|----------|
| 3 1/2" Cad | 2" | 1" | 868 |
| 3 1/2" Chrome | 2" | 1" | 869 |

SPLIT SAFETY COLLARS - STEEL



| Diameter | Item No. |
|---------------|----------|
| 1" Cad | 461 |
| 1" Chrome | 463 |
| 1-1/8" Cad | 462 |
| 1-1/8" Chrome | 464 |

SAFETY COLLARS STAINLESS STEEL



These safety collars are used on the rudder shaft and prop shaft.

| Diameter | Item No. |
|----------|----------|
| 3/4" | 402 |
| 7/8" | 403 |
| 1" | 400 |
| 1-1/8" | 401 |

STRUT COLLARS STAINLESS STEEL



These strut collars are used on propeller shaft ahead of the strut.

| Diameter | Item No. |
|----------|----------|
| 1" | 4001 |
| 1-1/8" | 4002 |

PROP NUT KIT STAINLESS STEEL



Item No.
723

COTTER PIN STAINLESS STEEL



Item No.
722

PROPELLER NUTS BRASS AND S.S.



Thread Size
3/4 - 10 (Brass)
Half Nut (S.S.)

Item No.
725
726

LOCKING PROPELLER NUTS STAINLESS STEEL



Thread Size
3/4 - 10
3/4 - 16

Item No.
727
727-F

PROPELLER KEYS STAINLESS STEEL



Size
1/4 x 1/4

Item No.
724